



HighLINER 2

Outdoor and indoor linear lighting

HighLINER 2 offers natural white illumination for soffits, awnings, and wall washes. It's easy to install for both new construction and retrofit. Easily daisy chain up to six 1,2-meter luminaires using lead wires located on both sides of the fixture. The co-extruded plastic housing diffuses the light and protects the luminaire to provide long operating life. This reduces maintenance costs, speeds up payback periods, and increases energy savings.



- Easy to install
- Lightweight fixture
- Illuminates soffits evenly

Specifications

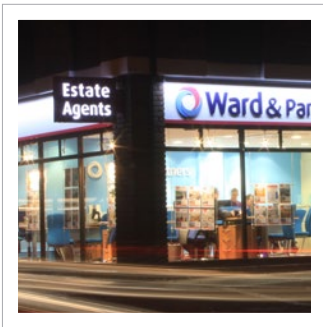

Part number	1,2 m	701912-C1I75
	0,3 m	701912-L1C1I75
Dimensions L x W x H	1,2 m	1161 mm x 60 mm x 28 mm
	0,3 m	304 mm x 60 mm x 28 mm
Lumens per fixture¹	1,2 m	1792
	0,3 m	448
Nominal colour temperature	5000 K	
Colour Rendering Index (CRI)	80 (nominal)	
Estimated product lifetime	100.000 hours (L ₇₀) ²	
Operating temperature	-25° C to +50° C	
Protection class	IP68	
Power¹	1,2 m	14,4 W
	0,3 m	3,6 W
Efficacy¹	124 lm/W (at LED)	
Fastening/packaging	1,2 m	3 mounting clips (400686) included 2 wire nut housing (400860) included
	0,3 m	2 mounting clips (400686) included 2 wire nut housing (400860) included
Power capacity	1,2 m – 6 units per SloanLED 100 W 24 VDC power supply 0,3 m – 24 units per SloanLED 100 W 24 VDC power supply	

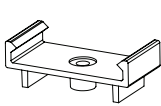
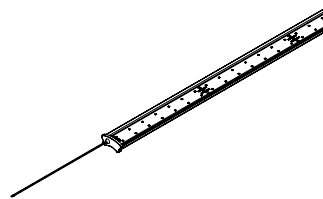

Mounting Clip

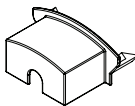

Wire Nut Housing

¹ Tolerance range for optical and electrical data: ±15%

² Based on LED component manufacturer data

